

Hermetic junction boxes

INDUSTRIAL IP65



Cover transparent
index with: X X X X- 01



Cover color the same as casing
Grey RAL 7035 index with X X X X -00



With cable glands
cover Grey RAL 7035* index : X X X X- 02



- Protection degree IP65
- Impact resistance IK07
- Sealing possibility casings
- Color obudowy Grey RAL 7035*
- Increased UV resistance
- Metal screws
- Elastic sealing

- CAD drawing available at www
- Sealed casing
- HALOGENFREE
- Available at many sizes

DIMENSIONS

Boxes hermetic INDUSTRIAL IP65

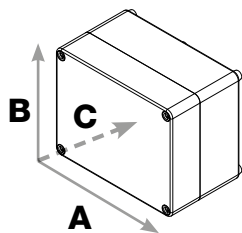

105 x 105

dimension A/B/C	index
105x105x66	2701-00
105x105x140	2702-00

105x105x66	2701-01
------------	---------

-00 casing grey RAL7035
-01 casing transparent



110 x 75

dimension A/B/C	index
110x75x59	2703-00
110x75x90	2704-00

110x75x59	2703-01
-----------	---------

-00 casing grey RAL7035
-01 casing transparent



135 x 74

dimension A/B/C	index
135x74x72	2705-00
135x74x105	2706-00

135x74x72	2705-01
-----------	---------

-00 casing grey RAL7035
-01 casing transparent



270 x 220

dimension A/B/C	index
270x220x106	2719-00
270x220x126	2720-00
270x220x168	2721-00

270x220x106	2719-01
270x220x126	2720-01
270x220x168	2721-01

-00 casing grey RAL7035
-01 casing transparent



280 x 220

dimension A/B/C	index
280x220x127	2722-00

-00 casing grey RAL7035



313 x 253

dimension A/B/C	index
313x253x115	2723-00
313x253x165	2724-00

313x253x115	2723-01
313x253x165	2724-01

-00 casing grey RAL7035
-01 casing transparent

DIMENSIONS

Boxes hermetic INDUSTRIAL IP65

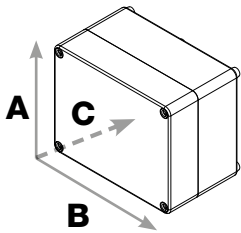

170 x 105

dimension A/B/C	index
170x105x82	2707-00
170x105x112	2708-00
170x105x82	2707-01

-00 casing grey RAL7035
-01 casing transparent



170 x 135

dimension A/B/C	index
170 x 135x147	2709-00
170x135x241	2710-00
170x135x85	2711-00
170x135x107	2712-00
170x135x145	2713-00
170x135x176	2714-00

170x135x241	2710-01
170x135x85	2711-01
170x135x107	2712-01

-00 casing grey RAL7035
-01 casing transparent



220 x 170

dimension A/B/C	index
220x170x86	2716-00
220x170x107	2717-00
220x170x146	2718-00
220x170x86	2716-01
220x170x107	2717-01
220x170x146	2718-01

-00 casing grey RAL7035
-01 casing transparent



340 x 270

dimension A/B/C	index
340x270x106	2725-00
340x270x165	2726-00
340x270x106	2725-01
340x270x165	2726-01

-00 casing grey RAL7035
-01 casing transparent



440 x 330

dimension A/B/C	index
440x330x145	2727-00
440x330x145	2727-01

-00 casing grey RAL7035
-01 casing transparent

DIMENSIONS

Boxes hermetic INDUSTRIAL IP65

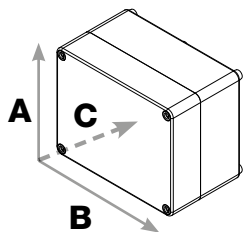

180x330

dimension A/B/C	index
180x330x130	2749-00



330x330

dimension A/B/C	index
330x330x130	2750-00



506x330

dimension A/B/C	index
506x330x13	2751-00



506x230

dimension A/B/C	index
130x95x58	2752-00



BOXES HERMETIC

- industrial quality
- hermetic IP65
- application in automation



DIMENSIONS

Boxes hermetic INDUSTRIAL IP65 with cable glands



102 x 102

dimension A/B/C	index
102x102x47	2700-02

-02 Grey RAL 7035*



129 x 129

dimension A/B/C	index
129x129x61	2701-02

-02 Grey RAL 7035*



130 x 95

dimension A/B/C	index
130x95x58	2703-02

-02 Grey RAL 7035*



156 x 95

dimension A/B/C	index
156x95x68	2705-02

-02 Grey RAL 7035*



198 x 95

dimension A/B/C	index
198x139x82	2707-02

-02 Grey RAL 7035*



198 x 163

dimension A/B/C	index
198x163x80	2711-02

-02 Grey RAL 7035*



249 x 198

dimension A/B/C	index
249x198x81	2716-02

-02 Grey RAL 7035*



305 x 244

dimension A/B/C	index
305x244x126	2721-02
305x244x168	2722-02

-02 Grey RAL 7035*



342 x 282

dimension A/B/C	index
342x282x115	2723-02
342x282x165	2724-02

-02 Grey RAL 7035*

IP 65 IK 07 400 V Br Cl



INDUSTRIAL JUNCTION BOX N/T 105X105X66 IP65

Type	Color	Pack.	Weight	Index
Industrial IP65	Grey RAL 7035	pc.	kg/1pc.	
		1	0,26	2701-00

NORM PN-EN-60670-1
 Inside dimensions: 99x99x56
 Outside dimensions: 105x105x66

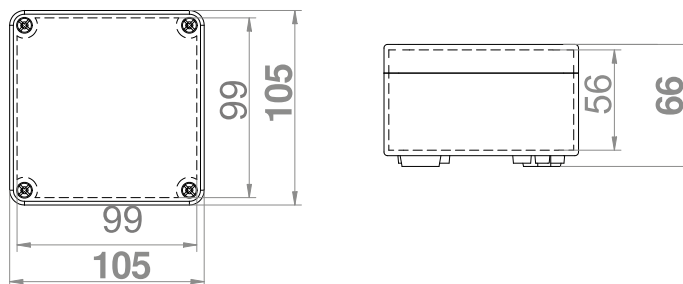

IP 65 IK 07 400 V Br Cl



INDUSTRIAL JUNCTION BOX N/T 105X105X140 IP65

Type	Color	Pack.	Weight	Index
Industrial IP65	Grey RAL 7035	pc.	kg/1pc.	
		1	0,25	2702-00

NORM PN-EN-60670-1
 Inside dimensions: 99x99x131
 Outside dimensions: 105x105x140

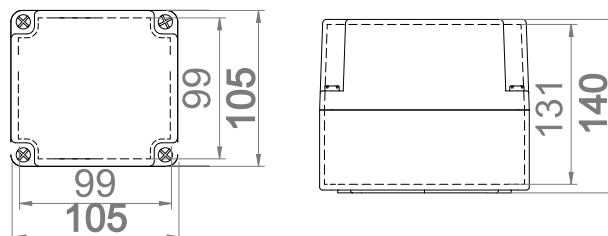

IP 65 IK 07 400 V Br Cl



INDUSTRIAL JUNCTION BOX N/T 110X75X59 IP65

Type	Color	Pack.	Weight	Index
Industrial IP65	Grey RAL 7035	pc.	kg/1pc.	
		1	0,15	2703-00

NORM PN-EN-60670-1
 Inside dimensions: 105x70x46
 Outside dimensions: 110x75x59

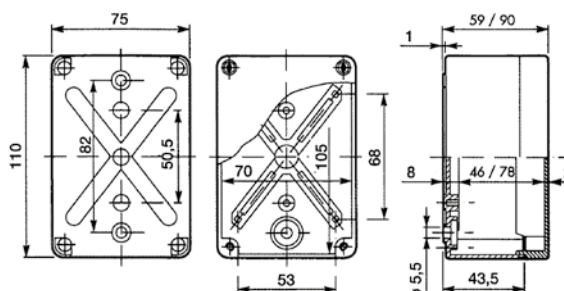

IP 65 IK 07 400 V Br Cl



INDUSTRIAL JUNCTION BOX N/T 110X75X90 IP65

Type	Color	Pack.	Weight	Index
Industrial IP65	Grey RAL 7035	1 pc.	0,24 kg/1pc.	2704-00

NORM PN-EN-60670-1
 Inside dimensions: 105x70x78
 Outside dimensions: 110x75x90

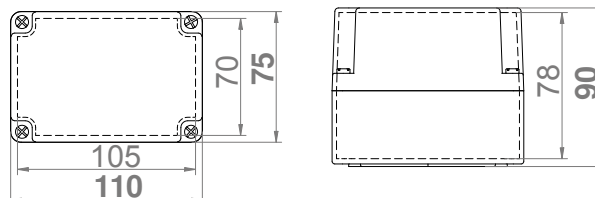

IP 65 IK 07 400 V Br Cl



INDUSTRIAL JUNCTION BOX N/T 135X74X72 IP65

Type	Color	Pack.	Weight	Index
Industrial IP65	Grey RAL 7035	1 pc.	0,22 kg/1pc.	2705-00

NORM PN-EN-60670-1
 Inside dimensions: 130x69x57
 Outside dimensions: 135x74x72

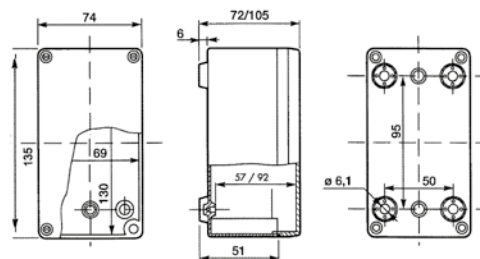

IP 65 IK 07 400 V Br Cl



INDUSTRIAL JUNCTION BOX N/T 135X74X105 IP65

Type	Color	Pack.	Weight	Index
Industrial IP65	Grey RAL 7035	1 pc.	0,22 kg/1pc.	2706-00

NORM PN-EN-60670-1
 Inside dimensions: 130x69x92
 Outside dimensions: 135x74x105

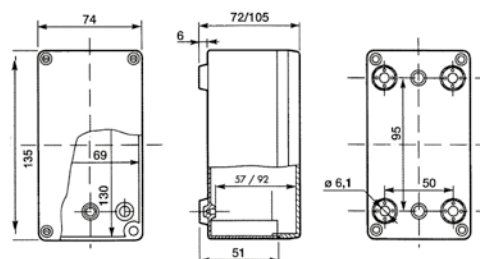

IP 65 IK 07 400 V Br Cl



INDUSTRIAL JUNCTION BOX N/T 170X105X82 IP65

Type	Color	Pack.	Weight	Index
		pc.	kg/1pc.	
Industrial IP65	Grey RAL 7035	1	0,46	2707-00

NORM PN-EN-60670-1
 Inside dimensions: 164x99x67
 Outside dimensions: 170x105x82

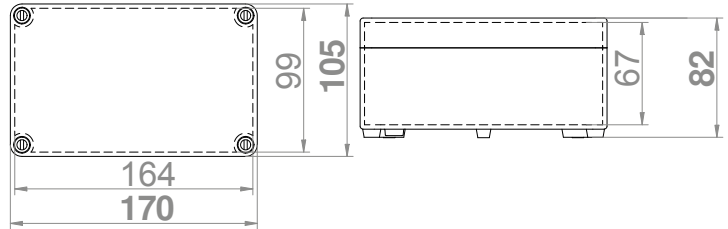

IP 65 IK 07 400 V Br Cl



INDUSTRIAL JUNCTION BOX N/T 170X105X112 IP65

Type	Color	Pack.	Weight	Index
		pc.	kg/1pc.	
Industrial IP65	Grey RAL 7035	1	0,61	2708-00

NORM PN-EN-60670-1
 Inside dimensions: 164x99x97
 Outside dimensions: 170x105x112

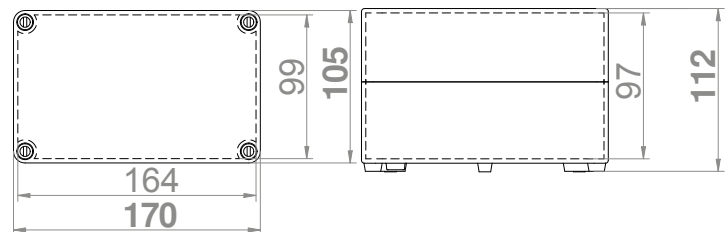

IP 65 IK 07 400 V Br Cl



INDUSTRIAL JUNCTION BOX N/T 170X135X147 IP65

Type	Color	Pack.	Weight	Index
		pc.	kg/1pc.	
Industrial IP65	Grey RAL 7035	1	0,60	2709-00

NORM PN-EN-60670-1
 Inside dimensions: 164x129x132
 Outside dimensions: 170x135x147

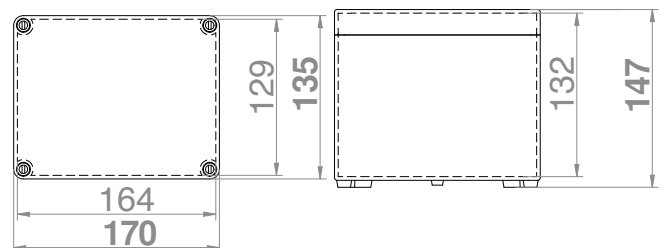

IP 65 IK 07 400 V Br Cl



INDUSTRIAL JUNCTION BOX N/T 170X135X241 IP65

Type	Color	Pack.	Weight	Index
Industrial IP65	Grey RAL 7035	1 pc.	0,63 kg/1pc.	2710-00

NORM PN-EN-60670-1
 Inside dimensions: 164x129x225
 Outside dimensions: 170x135x241

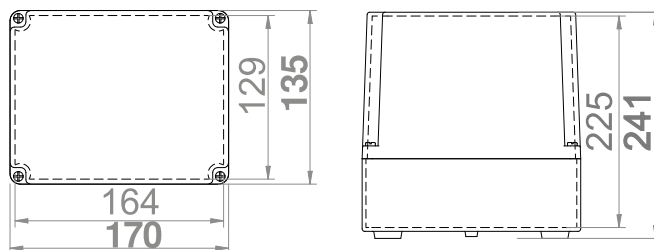

IP 65 IK 07 400 V Br Cl 2K



INDUSTRIAL JUNCTION BOX N/T 170X135X85 IP65

Type	Color	Pack.	Weight	Index
Industrial IP65	Grey RAL 7035	1 pc.	0,49 kg/1pc.	2711-00

NORM PN-EN-60670-1
 It is possible to make the cover sealing on request by the 2-component method.
 Inside dimensions: 164x129x70
 Outside dimensions: 170x135x85

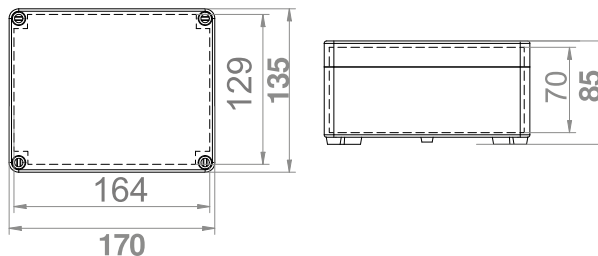

IP 65 IK 07 400 V Br Cl



INDUSTRIAL JUNCTION BOX N/T 170X135X107 IP65

Type	Color	Pack.	Weight	Index
Industrial IP65	Grey RAL 7035	1 pc.	0,50 kg/1pc.	2712-00

NORM PN-EN-60670-1
 Inside dimensions: 164x129x91
 Outside dimensions: 170x135x107

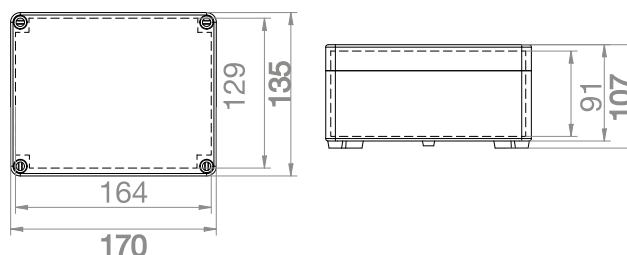

IP 65 IK 07 400 V Br Cl



INDUSTRIAL JUNCTION BOX N/T 170X135X145 IP65

Type	Color	Pack.	Weight	Index
Industrial IP65	Grey RAL 7035	pc.	kg/1pc.	
		1	0,69	2713-00

NORM PN-EN-60670-1
 Inside dimensions: 164x129x130
 Outside dimensions: 170x135x145

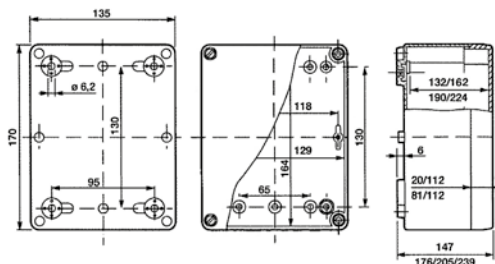

IP 65 IK 07 400 V Br Cl



INDUSTRIAL JUNCTION BOX N/T 170X135X176 IP65

Type	Color	Pack.	Weight	Index
Industrial IP65	Grey RAL 7035	pc.	kg/1pc.	
		1	0,46	2714-00

NORM PN-EN-60670-1
 Inside dimensions: 164x129x162
 Outside dimensions: 170x135x176

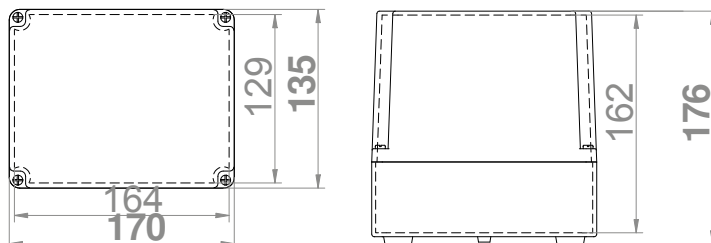

IP 65 IK 07 400 V Br Cl 2K



INDUSTRIAL JUNCTION BOX N/T 220X170X107 HINGED IP65

Type	Color	Pack.	Weight	Index
Industrial IP65	Grey RAL 7035	pc.	kg/1pc.	
		1	-	2717-03

NORM PN-EN-60670-1
 Inside dimensions: 214x162x102 mm
 Outside dimensions: 220x170x120 mm

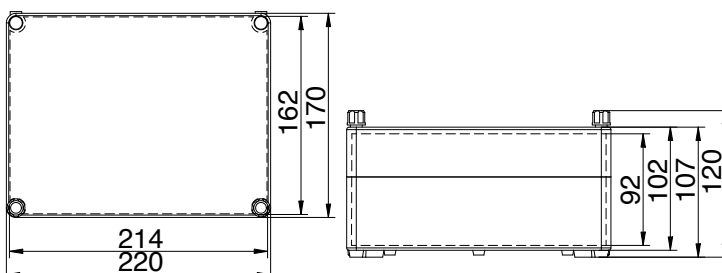

IP 65 IK 07 400 V Br Cl



INDUSTRIAL JUNCTION BOX N/T 220X170X86 IP65

Type	Color	Pack.	Weight	Index
Industrial IP65	Grey RAL 7035	1 pc.	0,75 kg/1pc.	2716-00

NORM PN-EN-60670-1
 Inside dimensions: 214x164x69
 Outside dimensions: 220x170x86

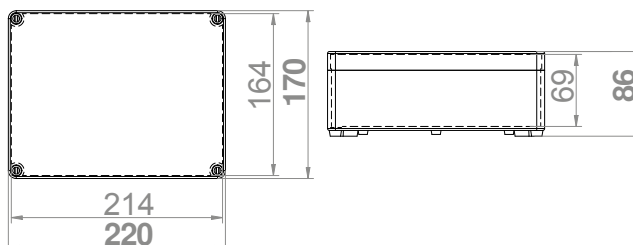

IP 65 IK 07 400 V Br Cl 2K



INDUSTRIAL JUNCTION BOX N/T 220X170X107 IP65

Type	Color	Pack.	Weight	Index
Industrial IP65	Grey RAL 7035	1 pc.	0,86 kg/1pc.	2717-00

NORM PN-EN-60670-1
 It is possible to make the cover sealing on request by the 2-component method.
 Inside dimensions: 214x164x91
 Outside dimensions: 220x170x107

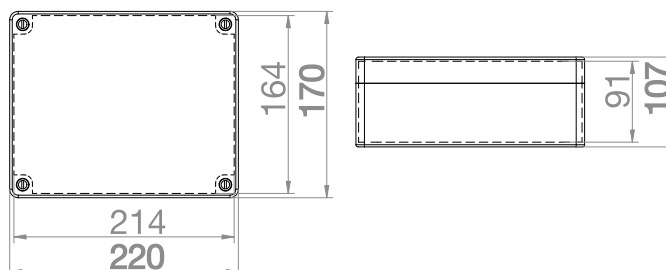

IP 65 IK 07 400 V Br Cl



INDUSTRIAL JUNCTION BOX N/T 220X170X146 IP65

Type	Color	Pack.	Weight	Index
Industrial IP65	Grey RAL 7035	1 pc.	1,00 kg/1pc.	2718-00

NORM PN-EN-60670-1
 Inside dimensions: 214x162x130
 Outside dimensions: 220x170x146

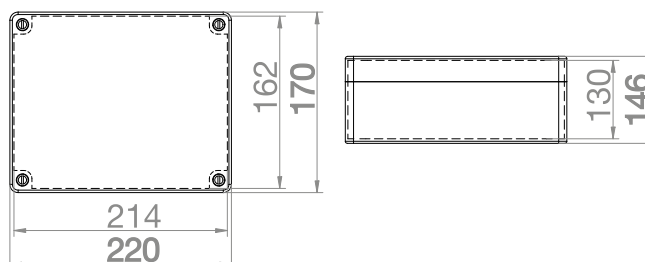

IP 65 IK 07 400 V Br Cl

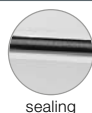

INDUSTRIAL JUNCTION BOX N/T 270X220X106 IP65

Type	Color	Pack. pc.	Weight kg/1pc.	Index
Industrial IP65	Grey RAL 7035	1	1,31	2719-00

NORM PN-EN-60670-1
Machine sealing.
Inside dimensions: 264x214x89
Outside dimensions: 270x220x106

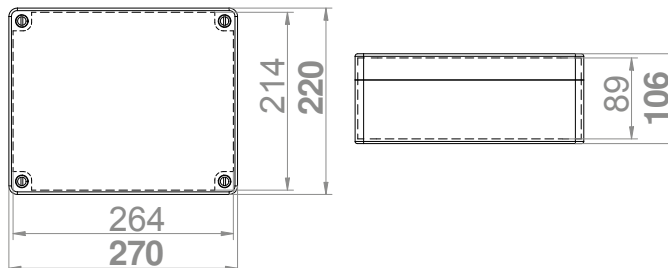

IP 65 IK 07 400 V Br Cl

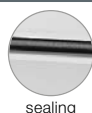

INDUSTRIAL JUNCTION BOX N/T 270X220X126 IP65

Type	Color	Pack. pc.	Weight kg/1pc.	Index
Industrial IP65	Grey RAL 7035	1	1,35	2720-00

NORM PN-EN-60670-1
Machine sealing.
Inside dimensions: 264x214x109
Outside dimensions: 270x220x126

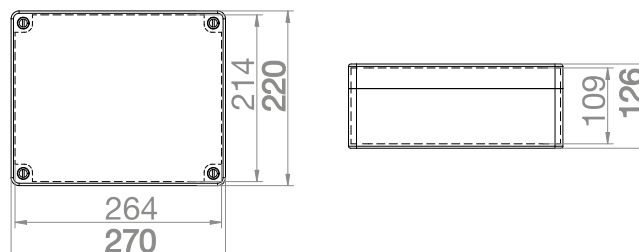

IP 65 IK 07 400 V Br Cl



INDUSTRIAL JUNCTION BOX N/T 270X220X168 IP65

Type	Color	Pack. pc.	Weight kg/1pc.	Index
Industrial IP65	Grey RAL 7035	1	1,49	2721-00

NORM PN-EN-60670-1
Machine sealing.
Inside dimensions: 264x214x151
Outside dimensions: 270x220x168

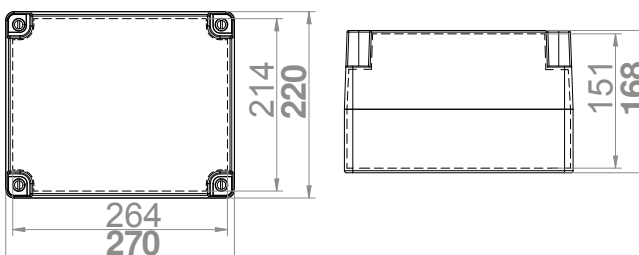

IP 65 IK 07 400 V Br Cl

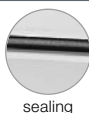

INDUSTRIAL JUNCTION BOX N/T 280X220X174 IP65

Type	Color	Pack.	Weight	Index
Industrial IP65	Grey RAL 7035	1 pc.	1,30 kg/1pc.	2722-00

NORM PN-EN-60670-1
Machine sealing.
Inside dimensions: 267x207x110
Outside dimensions: 280x220x174

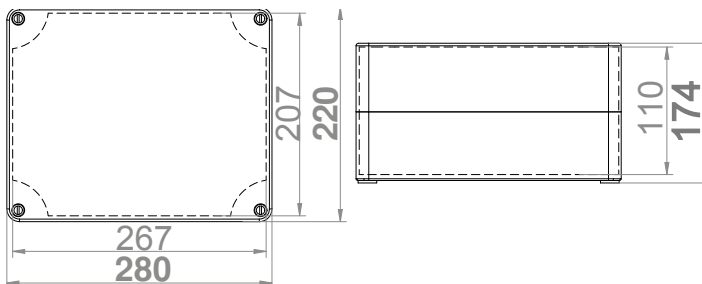

IP 65 IK 07 400 V Br Cl

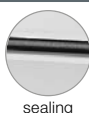

INDUSTRIAL JUNCTION BOX N/T 313X253X115 IP65

Type	Color	Pack.	Weight	Index
Industrial IP65	Grey RAL 7035	1 pc.	1,64 kg/1pc.	2723-00

NORM PN-EN-60670-1
Machine sealing.
Inside dimensions: 300x240x100
Outside dimensions: 313x253x115

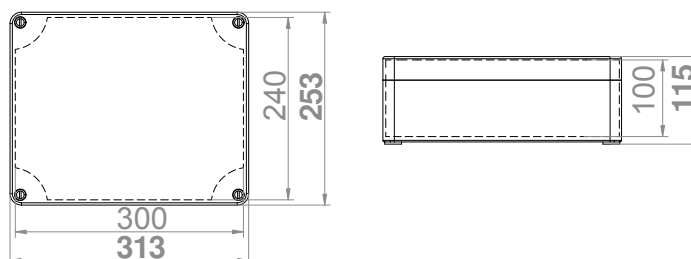

IP 65 IK 07 400 V Br Cl

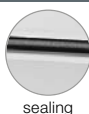

INDUSTRIAL JUNCTION BOX N/T 313X253X165 IP65

Type	Color	Pack.	Weight	Index
Industrial IP65	Grey RAL 7035	1 pc.	2,30 kg/1pc.	2724-00

NORM PN-EN-60670-1
Machine sealing.
Inside dimensions: 300x240x150
Outside dimensions: 313x253x165

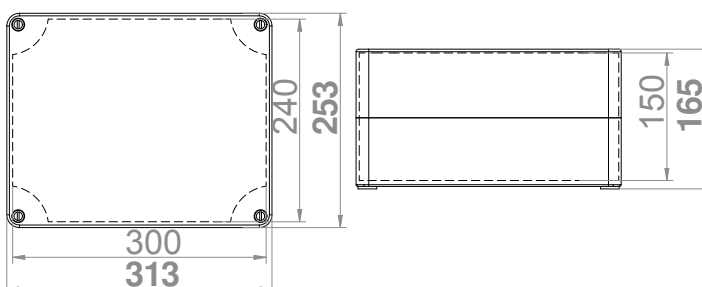

IP 65 IK 07 400 V Br Cl 2K



INDUSTRIAL JUNCTION BOX N/T 340X270X106 IP65

Type	Color	Pack.	Weight	Index
Industrial IP65	Grey RAL 7035	1 pc.	2,00 kg/1pc.	2725-00

NORM PN-EN-60670-1
Machine sealing.
Inside dimensions: 328x258x91
Outside dimensions: 340x270x106

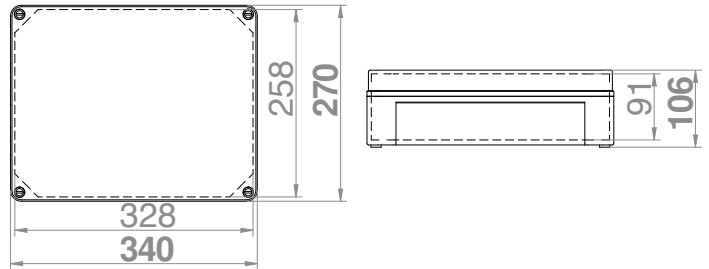

IP 65 IK 07 400 V Br Cl



INDUSTRIAL JUNCTION BOX N/T 340X270X165 IP65

Type	Color	Pack.	Weight	Index
Industrial IP65	Grey RAL 7035	1 pc.	2,50 kg/1pc.	2726-00

NORM PN-EN-60670-1
Machine sealing.
Inside dimensions: 328x258x154
Outside dimensions: 340x270x165

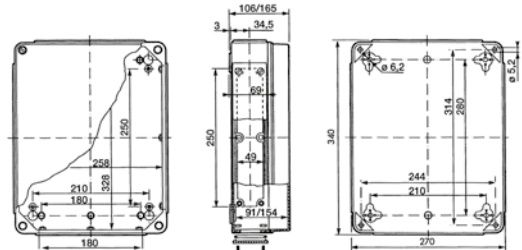

IP 65 IK 07 400 V Br Cl



INDUSTRIAL JUNCTION BOX N/T 440X330X145 IP65

Type	Color	Pack.	Weight	Index
Industrial IP65	Grey RAL 7035	1 pc.	3,20 kg/1pc.	2727-00

NORM PN-EN-60670-1
Machine sealing.
Plastic screws with springs. Quick cover assembly -01
Inside dimensions: 429x321x127
Outside dimensions: 440x330x145

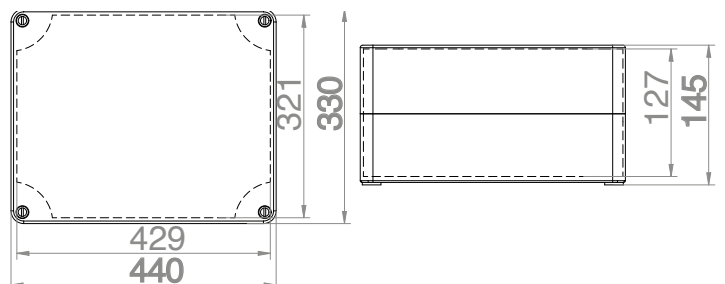

IP 65 650 °C Br 400 V ABS



INDUSTRIAL JUNCTION BOX N/T 180X330X130 IP65

Type	Color	Pack.	Waga	Index
IP65 enclosure	Grey RAL 7035	1 pc.	1,06 kg/1 szt.	2749-00

NORM: PN-IEC-60998-1:2006.
Dimensions: 188x330x130 mm

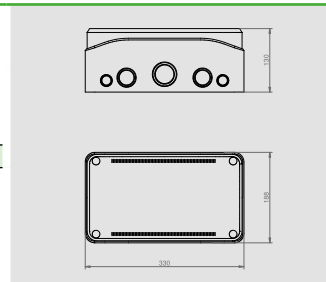

IP 65 650 °C Br 400 V ABS



INDUSTRIAL JUNCTION BOX N/T 330X330X130 IP65

Type	Color	Pack.	Weight	Index
IP65 enclosure	Grey RAL 7035	1 pc.	1,56 kg/1pc.	2750-00

NORM: PN-IEC-60998-1:2006.
Dimensions: 330x330x130 mm

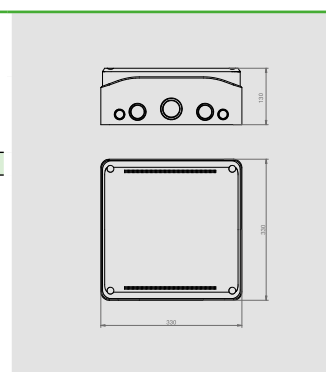

IP 65 650 °C Br 400 V ABS



INDUSTRIAL JUNCTION BOX N/T 514X330X130 IP65

Type	Color	Pack.	Waga	Index
IP65 enclosure	Grey RAL 7035	1 pc.	2,18 kg/1 szt.	2751-00

NORM: PN-IEC-60998-1:2006.
Dimensions: 514x330x130 mm

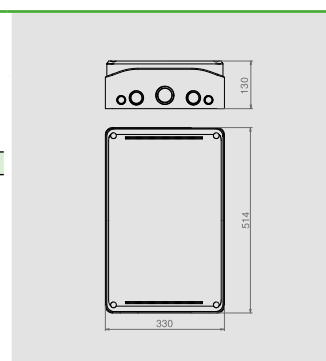

IP 65 650 °C Br 400 V ABS



INDUSTRIAL JUNCTION BOX N/T 506X230X130 IP65

Type	Color	Pack.	Waga	Index
IP65 enclosure	Grey RAL 7035	1 pc.	1,85 kg/1 szt.	2752-00

NORM: PN-IEC-60998-1:2006.
Dimensions: 506x230x130 mm

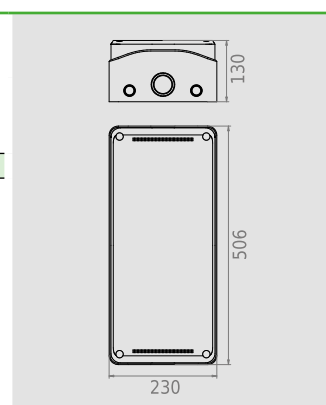

IP 65 IK 07 400 V PC



INDUSTRIAL JUNCTION BOX N/T 105X105X66 IP65 PC

Type	Color	Pack.	Weight	Index
		pc.	kg/1pc.	
Industrial IP65	Grey RAL 7035	1	0,25	2701-01

NORM PN-EN-60670-1
 Inside dimensions: 99x99x56
 Outside dimensions: 105x105x66

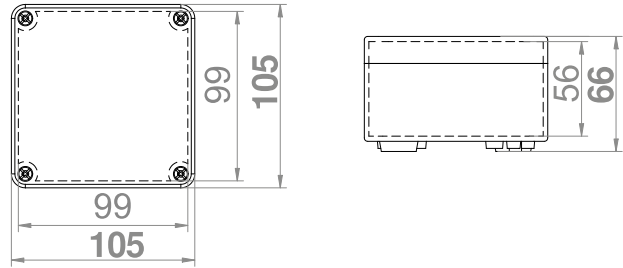

IP 65 IK 07 400 V PC



INDUSTRIAL JUNCTION BOX N/T 110X75X59 IP65 PC

Type	Color	Pack.	Weight	Index
		pc.	kg/1pc.	
Industrial IP65	Grey RAL 7035	1	0,22	2703-01

NORM PN-EN-60670-1
 Inside dimensions: 105x70x46
 Outside dimensions: 110x75x59

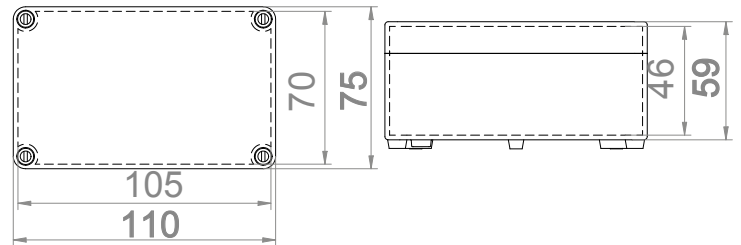

IP 65 IK 07 400 V PC



INDUSTRIAL JUNCTION BOX N/T 135X74X72 IP65 PC

Type	Color	Pack.	Weight	Index
Industrial IP65	Grey RAL 7035	1 pc.	0,34 kg/1pc.	2705-01

NORM PN-EN-60670-1
 Inside dimensions: 130x69x57
 Outside dimensions: 135x74x72

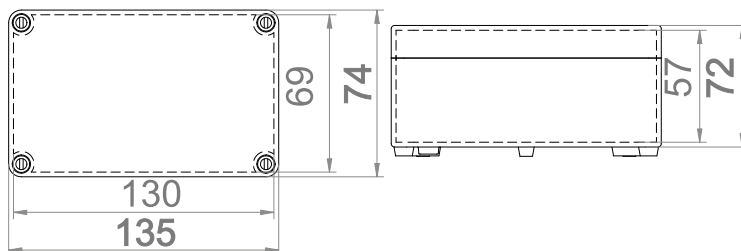

IP 65 IK 07 400 V PC



INDUSTRIAL JUNCTION BOX N/T 170X105X82 IP65 PC

Type	Color	Pack.	Weight	Index
Industrial IP65	Grey RAL 7035	1 pc.	0,37 kg/1pc.	2707-01

NORM PN-EN-60670-1
 Inside dimensions: 164x99x67
 Outside dimensions: 170x105x82

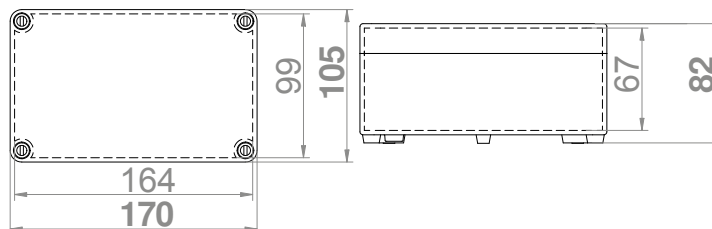

IP 65 IK 07 400 V PC



INDUSTRIAL JUNCTION BOX N/T 170X135X85 IP65 PC

Type	Color	Pack.	Weight	Index
		pc.	kg/1pc.	
Industrial IP65	Grey RAL 7035	1	0,40	2711-01

NORM PN-EN-60670-1
 Inside dimensions: 164x129x70
 Outside dimensions: 170x135x85

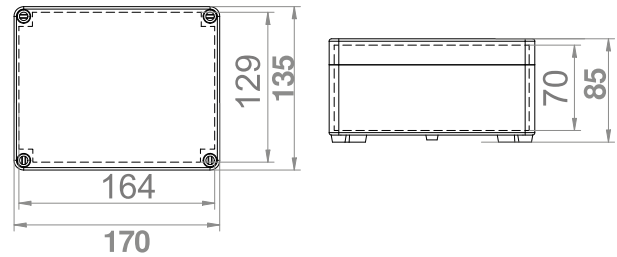

IP 65 IK 07 400 V PC



INDUSTRIAL JUNCTION BOX N/T 170X135X107 IP65 PC

Type	Color	Pack.	Weight	Index
		pc.	kg/1pc.	
Industrial IP65	Grey RAL 7035	1	0,56	2712-01

NORM PN-EN-60670-1
 Inside dimensions: 164x129x91
 Outside dimensions: 170x135x107

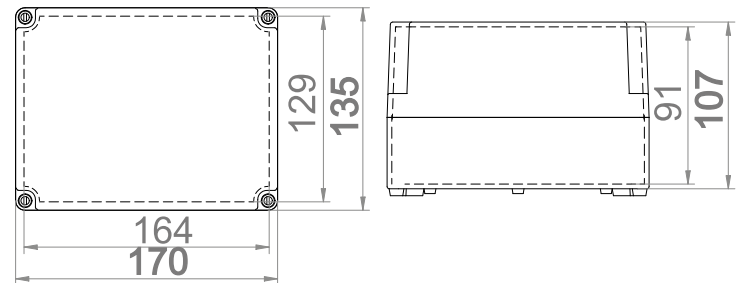

IP 65 IK 07 400 V PC



INDUSTRIAL JUNCTION BOX N/T 220X170X86 IP65 PC

Type	Color	Pack.	Weight	Index
		pc.	kg/1pc.	
Industrial IP65	Grey RAL 7035	1	0,65	2716-01

NORM PN-EN-60670-1
 Inside dimensions: 214x164x69
 Outside dimensions: 220x170x86

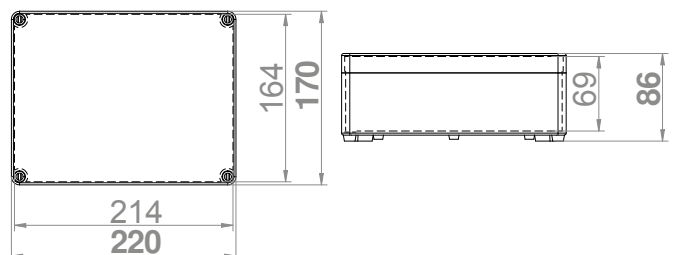

IP 65 IK 07 400 V PC



INDUSTRIAL JUNCTION BOX N/T 220X170X107 IP65 PC

Type	Color	Pack.	Weight	Index
Industrial IP65	Grey RAL 7035	1 pc.	0,80 kg/1pc.	2717-01

NORM PN-EN-60670-1
 Inside dimensions: 214x162x91
 Outside dimensions: 220x170x107

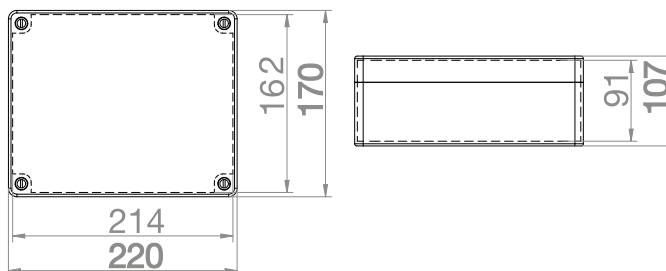

IP 65 IK 07 400 V PC



INDUSTRIAL JUNCTION BOX N/T 220X170X146 IP65 PC

Type	Color	Pack.	Weight	Index
Industrial IP65	Grey RAL 7035	1 pc.	0,85 kg/1pc.	2718-01

NORM PN-EN-60670-1
 Inside dimensions: 214x162x130
 Outside dimensions: 220x170x146

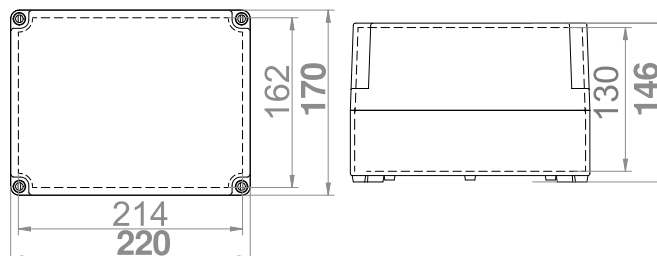

IP 65 IK 07 400 V PC



INDUSTRIAL JUNCTION BOX N/T 270X220X106 IP65 PC

Type	Color	Pack.	Weight	Index
Industrial IP65	Grey RAL 7035	1 pc.	1,00 kg/1pc.	2719-01

NORM PN-EN-60670-1
 Inside dimensions: 264x214x89
 Outside dimensions: 270x220x106

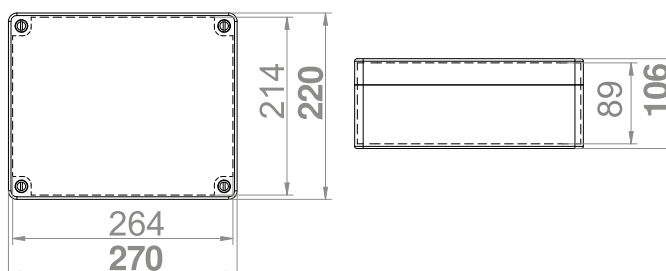

IP 65 IK 07 400 V PC



INDUSTRIAL JUNCTION BOX N/T 270X220X126 IP65 PC

Type	Color	Pack.	Weight	Index
Industrial IP65	Grey RAL 7035	pc.	kg/1pc.	
		1	1,20	2720-01

NORM PN-EN-60670-1
 Inside dimensions: 264x214x109
 Outside dimensions: 270x220x126

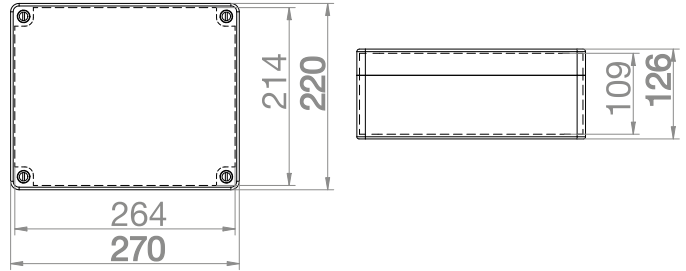

IP 65 IK 07 400 V PC



INDUSTRIAL JUNCTION BOX N/T 270X220X168 IP65 PC

Type	Color	Pack.	Weight	Index
Industrial IP65	Grey RAL 7035	pc.	kg/1pc.	
		1	1,49	2721-01

NORM PN-EN-60670-1
 Inside dimensions: 264x214x151
 Outside dimensions: 270x220x168

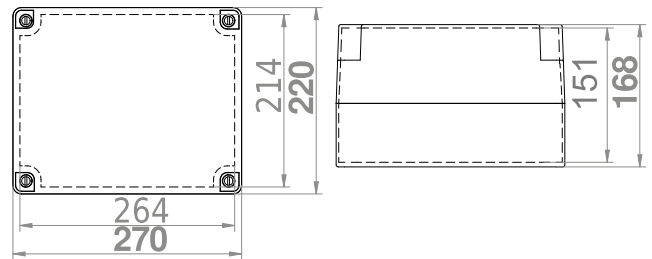

IP 65 IK 07 400 V PC



INDUSTRIAL JUNCTION BOX N/T 313X253X115 IP65 PC

Type	Color	Pack.	Weight	Index
Industrial IP65	Grey RAL 7035	pc.	kg/1pc.	
		1	1,25	2723-01

NORM PN-EN-60670-1
 Inside dimensions: 300x240x100
 Outside dimensions: 313x253x115

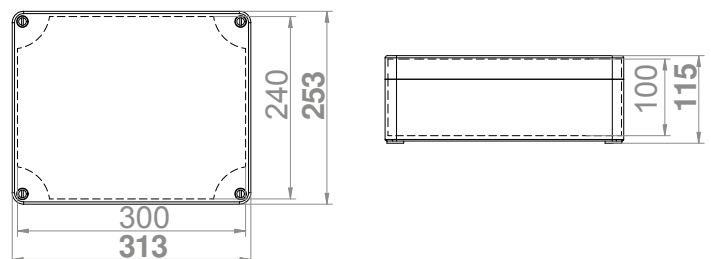

IP 65 IK 07 400 V PC



INDUSTRIAL JUNCTION BOX N/T 313X253X165 IP65 PC

Type	Color	Pack.	Weight	Index
Industrial IP65	Grey RAL 7035	1 pc.	1,85 kg/1pc.	2724-01

NORM PN-EN-60670-1
 Inside dimensions: 300x240x150
 Outside dimensions: 313x253x165

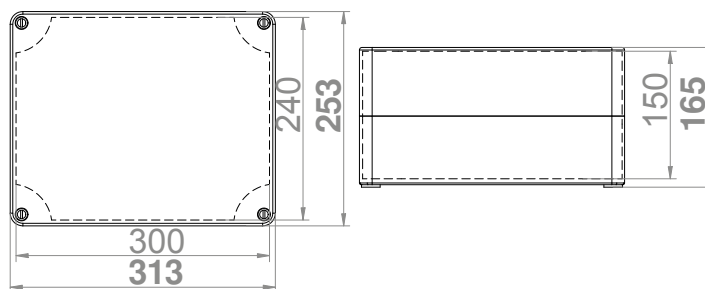

IP 65 IK 07 400 V PC



INDUSTRIAL JUNCTION BOX N/T 340X270X106 PC

Type	Color	Pack.	Weight	Index
Industrial IP65	Grey RAL 7035	1 pc.	1,45 kg/1pc.	2725-01

NORM PN-EN-60670-1
 Inside dimensions: 328x258x91
 Outside dimensions: 340x270x106

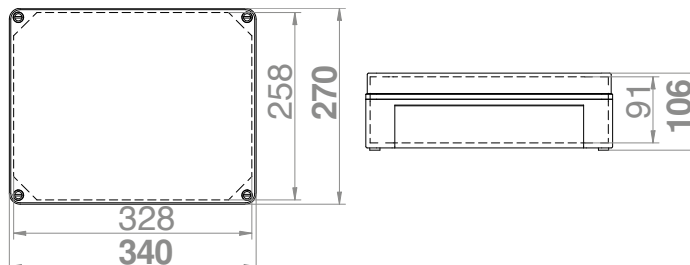

IP 65 IK 07 400 V PC



INDUSTRIAL JUNCTION BOX N/T 340X270X165 IP65 PC

Type	Color	Pack.	Weight	Index
Industrial IP65	Grey RAL 7035	1 pc.	- kg/1pc.	2726-01

NORM PN-EN-60670-1
 Inside dimensions: 328x258x151
 Outside dimensions: 340x270x165

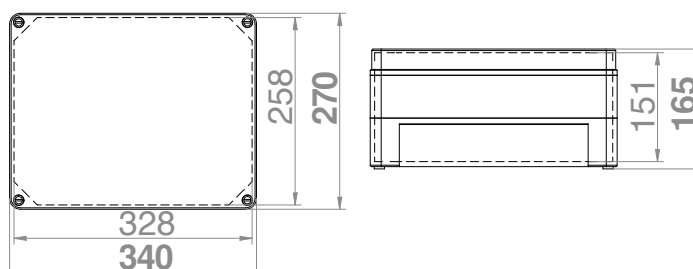

IP 65 IK 07 400 V PC



INDUSTRIAL JUNCTION BOX N/T 440X330X145 IP65 PC

Type	Color	Pack.	Weight	Index
		pc.	kg/1pc.	
Industrial IP65	Grey RAL 7035	1	3,20	2727-01

NORM PN-EN-60670-1
 Inside dimensions: 429x321x127
 Outside dimensions: 440x330x145

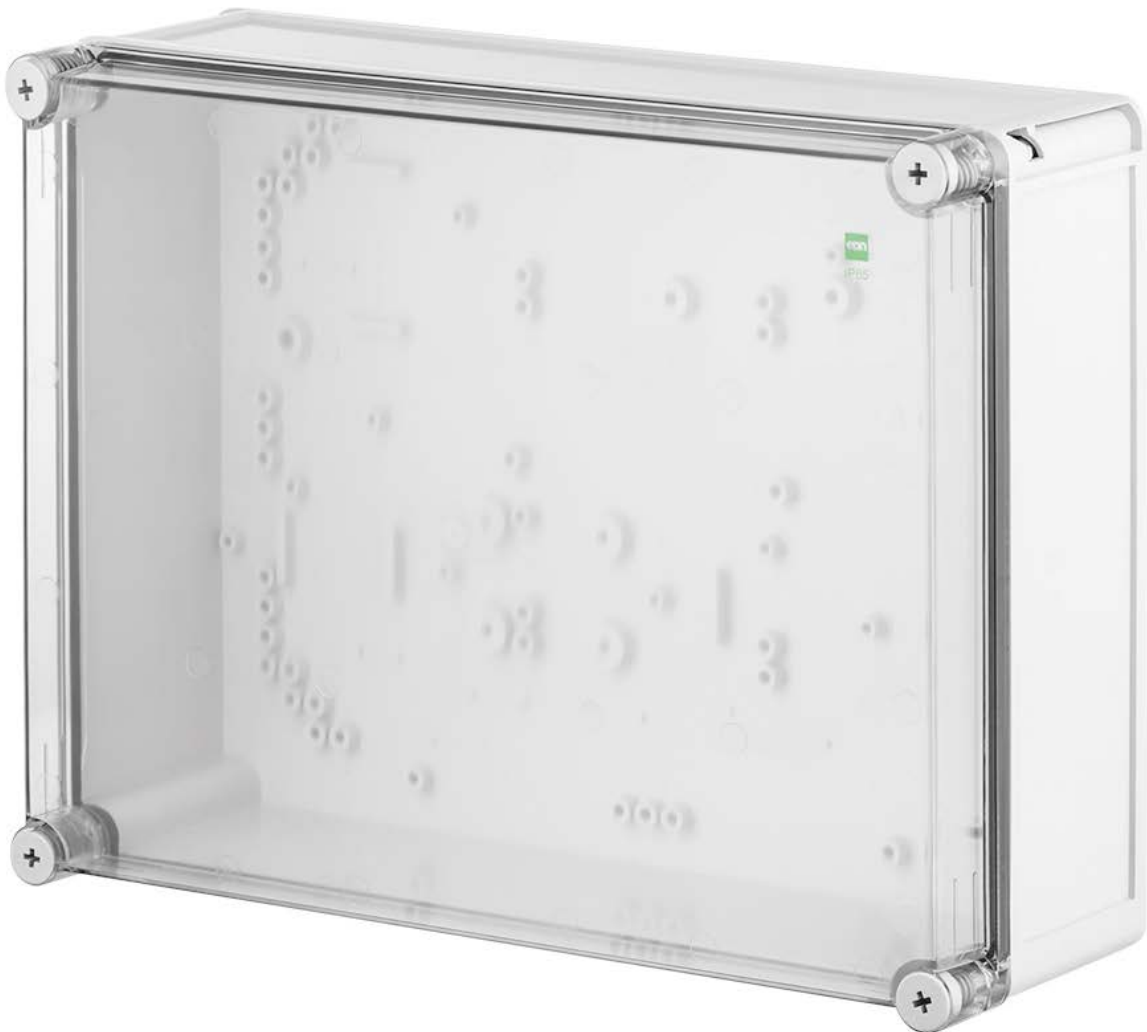
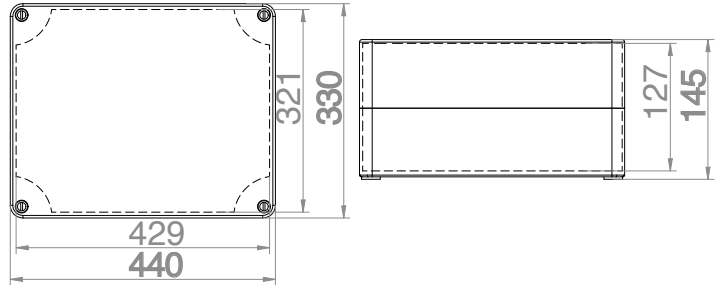

- sturdy locks with springs
- cover: polycarbonate >PC<
- machine sealing

IP 55 IK 07 400 V Br Cl

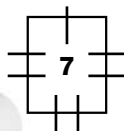

INDUSTRIAL JUNCTION BOX N/T 102X102X47 WITH 7 GLANDS

Type	Color	Pack.	Weight	Index
Industrial IP55	Grey RAL 7035	1 pc.	kg/1pc.	2700-02

NORM PN-EN-60670-1
 Inside dimensions: 65x65x30
 Outside dimensions: 102x102x47

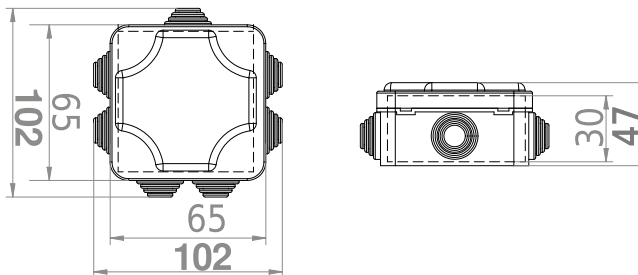

IP 55 IK 07 400 V Br Cl

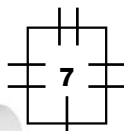

INDUSTRIAL JUNCTION BOX N/T 129X129X61 WITH 7 GLANDS

Type	Color	Pack.	Weight	Index
Industrial IP55	Grey RAL 7035	1 pc.	kg/1pc.	2701-02

NORM PN-EN-60670-1
 Inside dimensions: 100x100x50
 Outside dimensions: 129x129x61

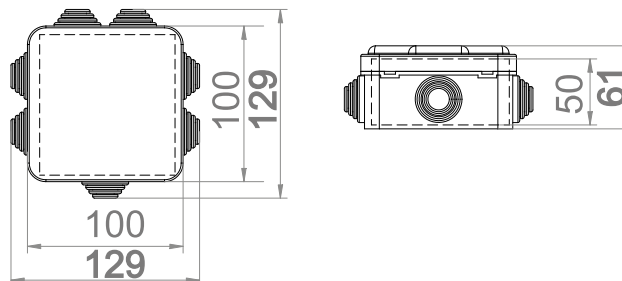

IP 55 IK 07 400 V Br Cl

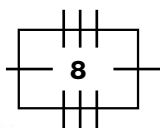

INDUSTRIAL JUNCTION BOX N/T 130X95X58 WITH 8 GLANDS

Type	Color	Pack.	Weight	Index
Industrial IP55	Grey RAL 7035	1 pc.	kg/1pc.	2703-02

NORM PN-EN-60670-1
 Inside dimensions: 105x70x48
 Outside dimensions: 130x95x58

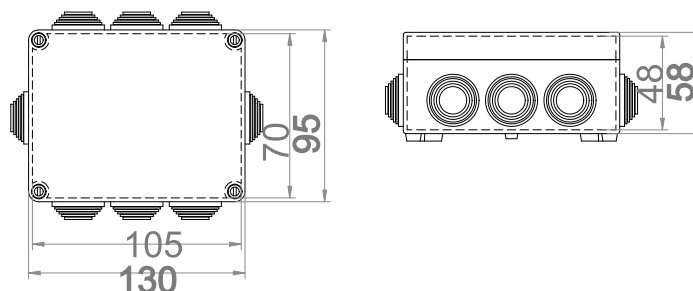

IP 55 IK 07 400 V Br Cl

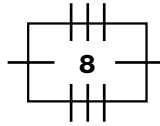

INDUSTRIAL JUNCTION BOX N/T 156X95X68 WITH 8 GLANDS

Type	Color	Pack.	Weight	Index
Industrial IP55	Grey RAL 7035	1 pc.	kg/1pc.	2705-02

NORM PN-EN-60670-1
 Inside dimensions: 130x69x57
 Outside dimensions: 156x95x68

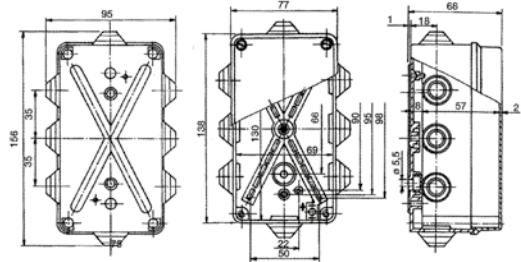

IP 55 IK 07 400 V Br Cl

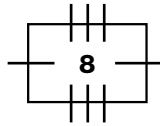

INDUSTRIAL JUNCTION BOX N/T 198X139X82 WITH 8 GLANDS

Type	Color	Pack.	Weight	Index
Industrial IP55	Grey RAL 7035	1 pc.	kg/1pc.	2707-02

NORM PN-EN-60670-1
 Inside dimensions: 164x99x68
 Outside dimensions: 198x139x82

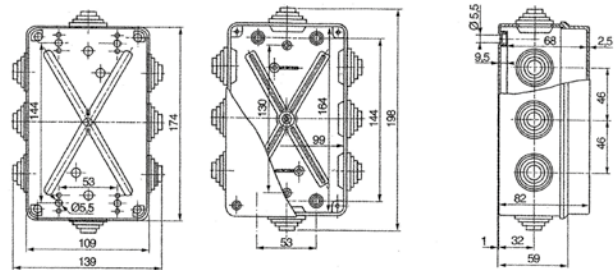

IP 55 IK 07 400 V Br Cl

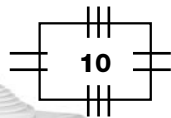

INDUSTRIAL JUNCTION BOX N/T 198X163X80 WITH 10 GLANDS

Type	Color	Pack.	Weight	Index
Industrial IP55	Grey RAL 7035	1 pc.	kg/1pc.	2711-02

NORM PN-EN-60670-1
 Inside dimensions: 164x129x68
 Outside dimensions: 198x163x80

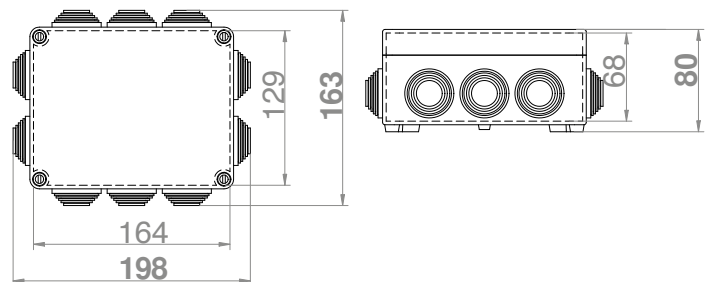

IP 55 IK 07 400 V Br Cl

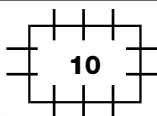

INDUSTRIAL JUNCTION BOX N/T 249X198X81 WITH 10 GLANDS

Type	Color	Pack.	Weight	Index
Industrial IP55	Grey RAL 7035	1 pc.	kg/1pc.	2716-02

NORM PN-EN-60670-1
 Inside dimensions: 214x162x69
 Outside dimensions: 249x198x81

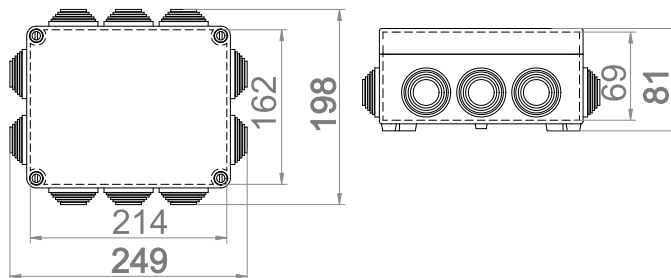

IP 55 IK 07 400 V Br Cl

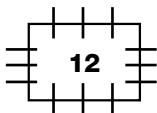

INDUSTRIAL JUNCTION BOX N/T 305X244X126 WITH 12 GLANDS

Type	Color	Pack.	Weight	Index
Industrial IP55	Grey RAL 7035	1 pc.	kg/1pc.	2721-02

NORM PN-EN-60670-1
 Inside dimensions: 267x207x111
 Outside dimensions: 305x244x126

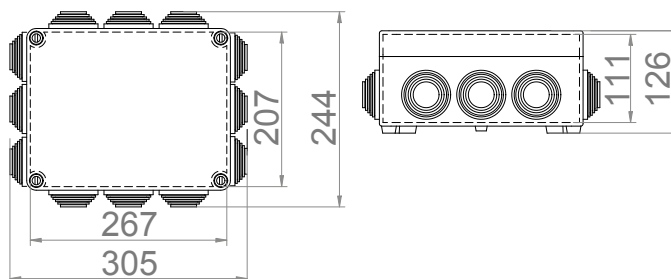

IP 55 IK 07 400 V Br Cl

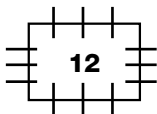

INDUSTRIAL JUNCTION BOX N/T 305X244X168 WITH 12 GLANDS

Type	Color	Pack.	Weight	Index
Industrial IP55	Grey RAL 7035	1 pc.	kg/1pc.	2722-02

NORM PN-EN-60670-1
 Inside dimensions: 267x207x153
 Outside dimensions: 305x244x168

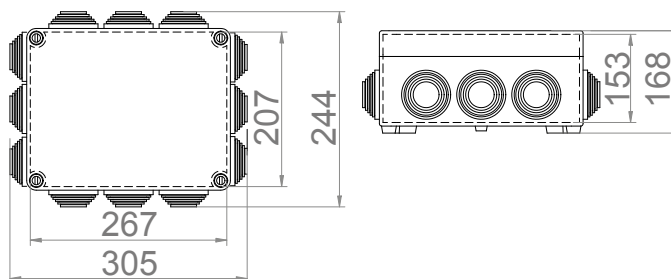

IP 55 IK 07 400 V Br Cl

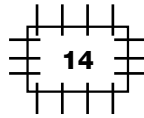

INDUSTRIAL JUNCTION BOX N/T 342X282X115 WITH 14 GLANDS

Type	Color	Pack.	Weight	Index
		pc.	kg/1pc.	
Industrial IP55	Grey RAL 7035	1	-	2723-02

NORM PN-EN-60670-1
 Inside dimensions: 300x240x100
 Outside dimensions: 342x282x115

IP 55 IK 07 400 V Br Cl

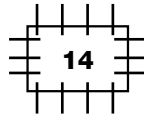

INDUSTRIAL JUNCTION BOX N/T 342X282X165 WITH 14 GLANDS

Type	Color	Pack.	Weight	Index
		pc.	kg/1pc.	
Industrial IP55	Grey RAL 7035	1	-	2724-02

NORM PN-EN-60670-1
 Inside dimensions: 300x240x150
 Outside dimensions: 342x282x165