

HYBRID CONNECTION RAIL TERMINAL BLOCKS

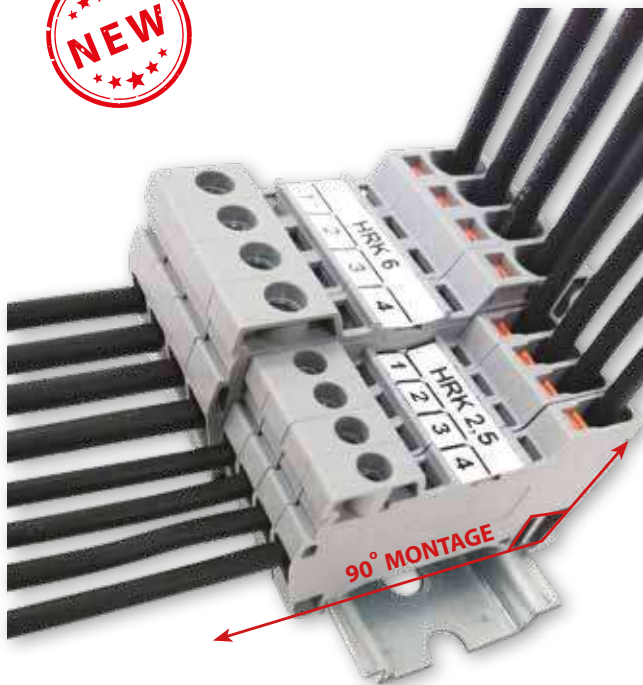
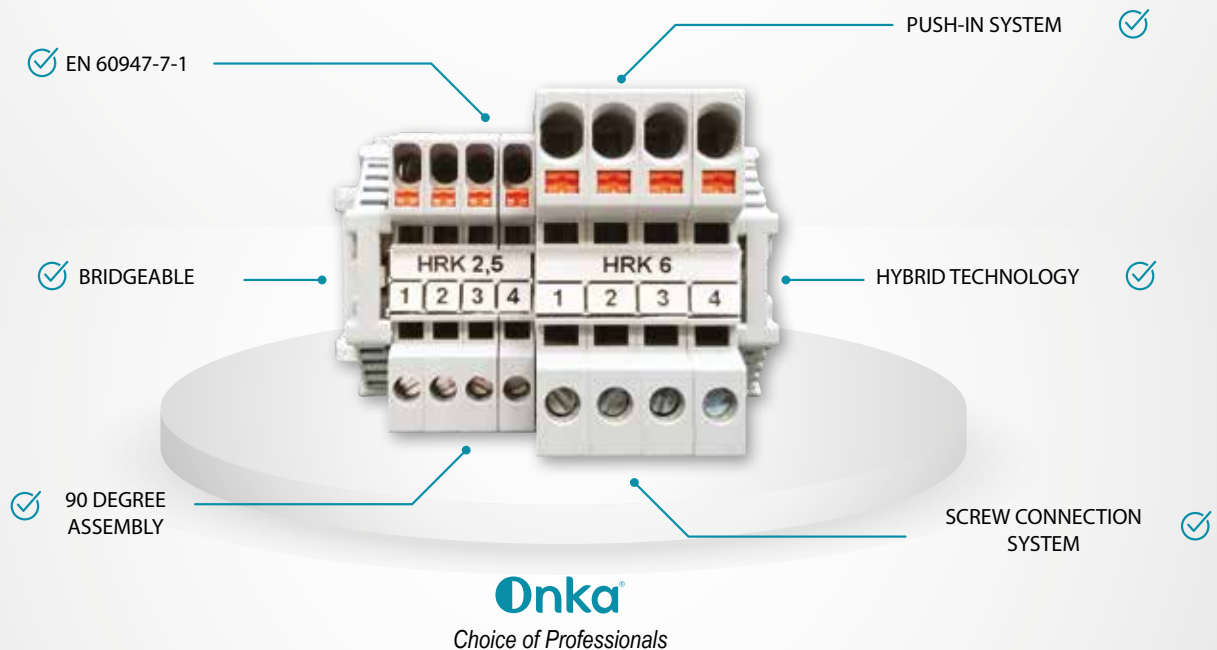

- Coordination between assembler and operator
- Ergonomic and aesthetics inside panels with 90° connection possibility
- Distribution and collection solutions through multi-connection circuit
- Bridging possibilities withing rated current
- EN 60947-7-1 directive
- 2,5mm² ve 6 mm² Cable Sections
- 10 Different Color Options
- From 0.34 mm² to 6 mm² With/Without end Terminals, Single Core / Multiple Core (Flexible) Connections
- Color Coding / Dekafix / Roll Labelling

ACCESSORIES

- 35 mm DIN Rail
- 2.5 and 6 mm² Cross Connections
- MRK and OPK Series Dekafixes
- MRK and OPK Series Stoppers

MOUNTABLE RAIL TYPES

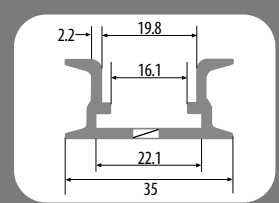
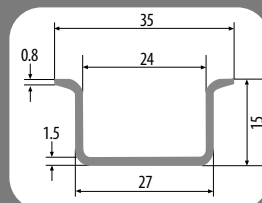
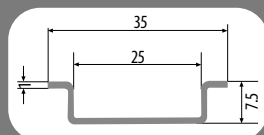

HRK HYBRID TERMINAL BLOCKS

**HRK 2,5**

New Code: 1040002
Old Code: 0362

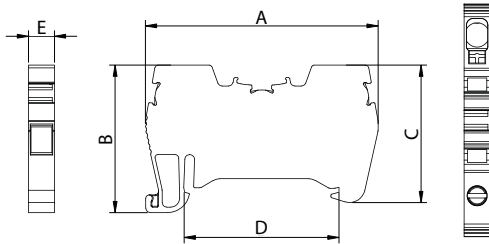

Dimension (mm)	A	B	C	D	E
	52	33	30,75	34,5	5,8

MATERIAL

Body	PA6.6	Spring	Stainless Steel
Bridge	Copper	Temp.	-40 °C, +140 °C
Contact	CK45 Steel	Cable Strip L.	10 mm
Screw	Steel	Torque	0,4 Nm

DATA	TSE / CE
Voltage	750 V
Current	24 A
Section	2,5 mm ²
Norm	EN-60947-7-1

COLOURS

COLOUR	V2	V2	V0	V0	Pcs.
	New Code	Old Code	New Code	Old Code	
GREY	1040002	0362	1040022	0332	100
CREAM	1040003		1040023		100
BLACK	1040004		1040024		100
BLUE	1040005		1040025		100
BROWN	1040006		1040026		100
RED	1040007		1040027		100
YELLOW	1040008		1040028		100
GREEN	1040009		1040029		100

ACCESSORIES

Cross Connection	New Code	Old Code	Section	Pcs.	See Page
		1060106	1925	2,5 / 2	100
	1060107	1926	2,5 / 3	100	Pg. 37
	1060108	1927	2,5 / 4	75	Pg. 37
	1060109	1928	2,5 / 10	30	Pg. 37
	1060110	1929	2,5 / 20	20	Pg. 37
Stopper	1060002	1202		100	Pg. 35
	1060005	1212		100	Pg. 34
	1060014	1222		100	Pg. 35
Group Sticker	1060024	1232		100	Pg. 34

MARKING

Dekafix	New Code	Old Code	See Page
		1060192	4440
	1060194	4442	Pg. 173
	-	9540	Pg. 179
	-	9770	Pg. 175, 176
Roll Label	-	8943-S11	Pg. 169

**HRK 6**

New Code 1040012
Old Code 0372

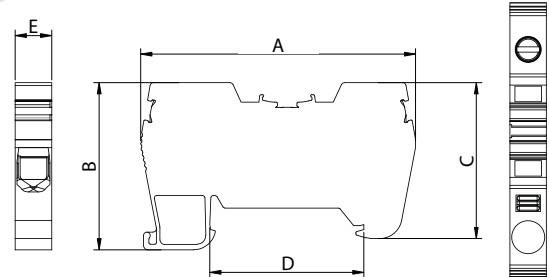

Dimension (mm)	A	B	C	D	E
	61,8	37,6	35	34,5	8,2

MATERIAL

Body	PA6.6	Spring	Stainless Steel
Bridge	Copper	Temp.	-40 °C, +140 °C
Contact	CK45 Steel	Cable Strip L.	10 mm
Screw	Steel	Torque	0,4 Nm

DATA	TSE / CE
Voltage	750 V
Current	41 A
Section	6 mm ²
Norm	EN-60947-7-1

COLOURS

COLOUR	V2	V2	V0	V0	Pcs.
	New Code	Old Code	New Code	Old Code	
GREY	1040012	0372	1040032	0342	100
CREAM	1040013		1040033		100
BLACK	1040014		1040034		100
BLUE	1040015		1040035		100
BROWN	1040016		1040036		100
RED	1040017		1040037		100
YELLOW	1040018		1040038		100
GREEN	1040019		1040039		100

ACCESSORIES

Cross Connection	New Code	Old Code	Section	Pcs.	See Page
		1060116	1935	6 / 2	100
	1060117	1936	6 / 3	50	Pg. 37
	1060118	1937	6 / 4	50	Pg. 37
	1060119	1938	6 / 10	15	Pg. 37
	1060120	1939	6 / 20	10	Pg. 37
Stopper	1060002	1202		100	Pg. 35
	1060005	1212		100	Pg. 34
	1060014	1222		100	Pg. 35
Group Sticker	1060024	1232		100	Pg. 34

MARKING

Dekafix	New Code	Old Code	See Page
		1060188	2630
	1060194	4442	Pg. 173
	-	9540	Pg. 179
	-	9770	Pg. 175-177
Roll Label	-	8943-S11	Pg. 169